

## Coaxial High Power Circulators

Part Number: KTCC301-400

### Key Features

- Frequency Range: 2.7GHz-3.5GHz
- High Power Handling, Duty Ratio 30%
- Low Insertion Loss, High Isolation
- Wide Operating Temperature Range: -30°C~+70°C
- Commercial, Military and Space Applications

### Electrical Specifications at Room (25°C±5°C) Temperature

Part Number	Working Frequency (GHz)	Insertion Loss Max (dB)	Isolation Min. (dB)	VSWR Max.	Peak Power (W)	Duty Ratio	Connector Type
KTCC301-400	2.7 - 3.5	0.5	20	1.25	500	30%	SMA/N

### Mechanical Dimensions (mm)

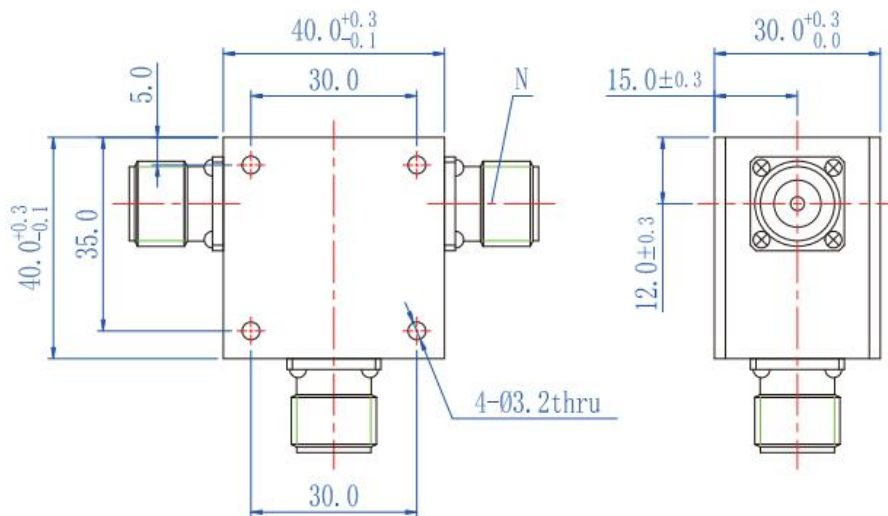

### HOW TO ORDER

